

HPW340-L70T2 Lathe Welding Auto Machinery



- Propose welding the way :MIG/MAG;TIG;Plasma welding

- Attention :**

The design of the jig, it needs cooperating with strok of the clamp center, so as to ensure that clamp and relaxes the work piece rapidly.

$$C \geq A + B$$

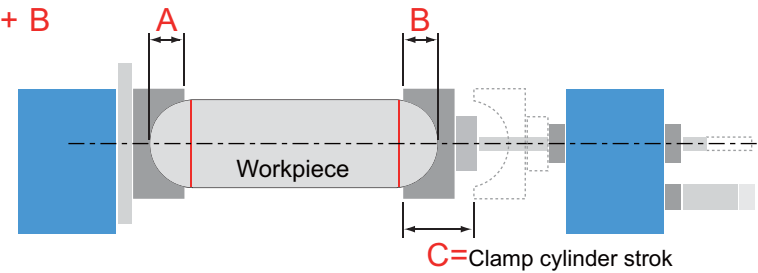

- Operation example

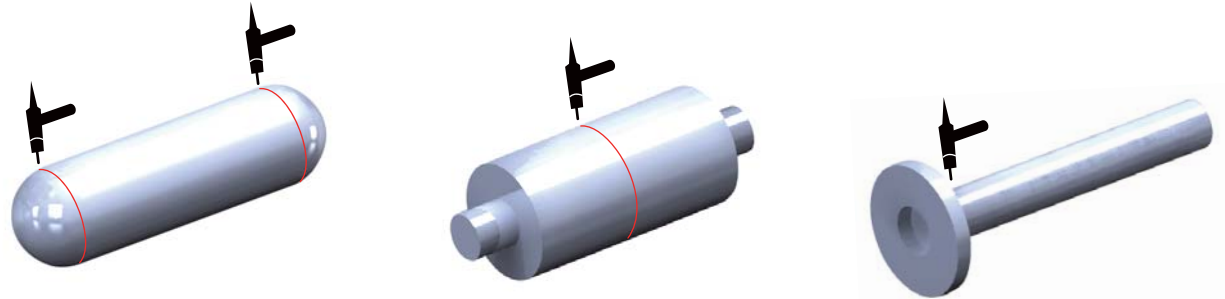

Specification / NO.	HPW340-L70T2
Power	AC 380V / 10A / 50Hz /1Ø
Permit the electric current	300A / 100% x 2set
Table Dia.	340mm.
Spindle Thru Hole	60mm.
Table speed	0.6 - 6.0 rpm.
Rotate load	250Kgs.
Rotate torque	675 Kg-cm
Workpiece Max. Dia	800mm.
Workpiece Max. Length	700mm.
Clamp cylinder strok(C)	150mm.
Clamp center hole	53 - 106mm.
Pressurize axis Dia.	50mm.
Over Lap timer(Fixing point)	0 - 99.9 sec (Digital display , unit : 0.1sec)
Timer (Fixing point)	0 - 999 sec (Digital display , unit :1sec)
Start / Crater arc tim	0 - 99.9 sec (Digital display , unit : 0.1sec)
Arc way of the welder	2 Cycle / 4 Cycle
Stop the brake	Magnetism brake
H.F. Protect	92%

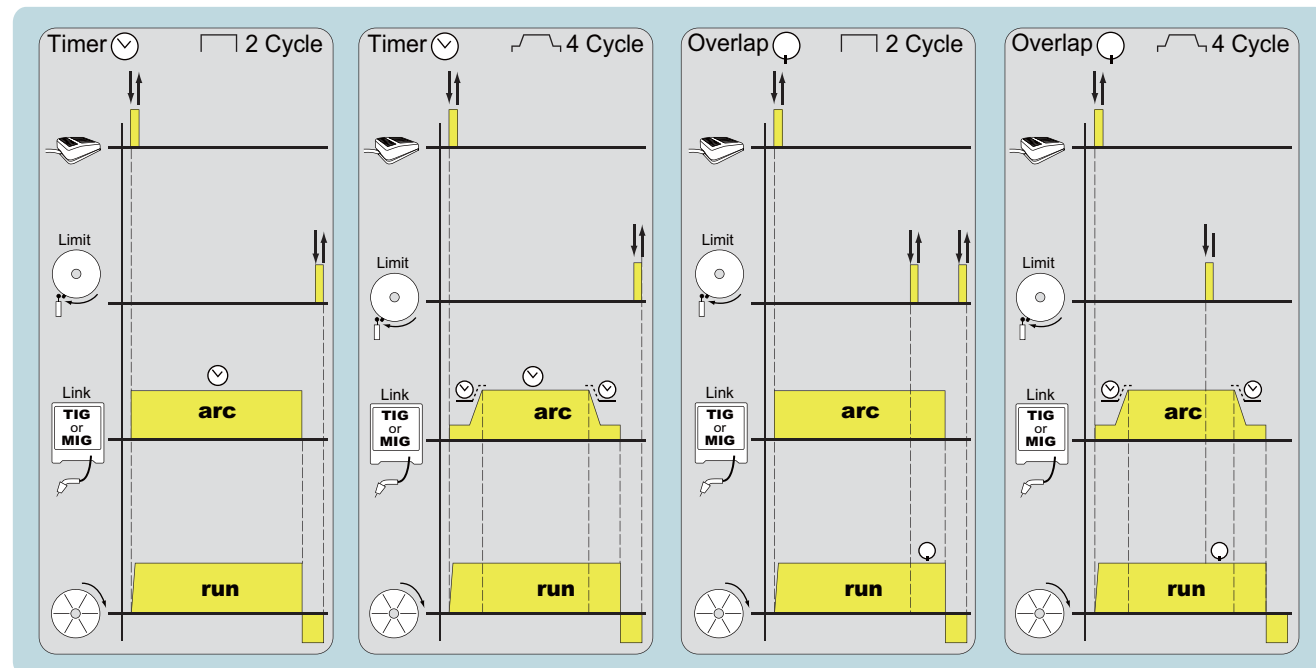

HPW340-L70T2 Lathe Welding Auto Machinery



Standard Accessories

Q'TY:1



Model: **HPT3**
 Name: Torch Stand
 Use the purpose:
 Torch mounts stroke: X:75mm. Y:100mm. Z:100mm.
 Torch setting stroke: 50mm.

OPTION



Model: **HPR2M**
 Name: Manually idle roller
 Use the purpose:
 Support the workpiece Max. Dia.600mm.



Model: **TW-4RA**
 Name: TIG&PLASMA Weld cold wire feeder
 Use the purpose:
 Wire Dia: 0.8 ~ 1.6mm
 Please Consult TW-4RA Catalogues

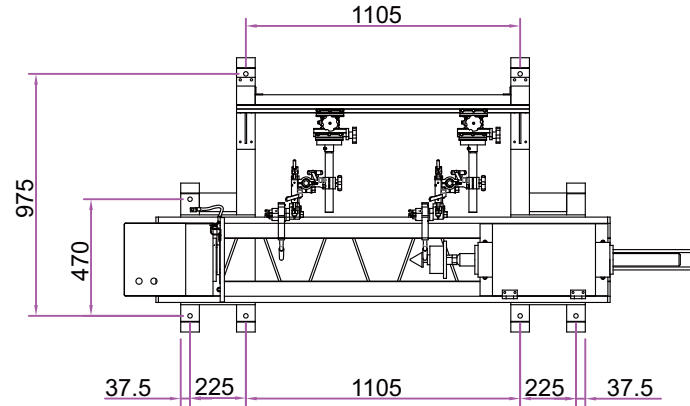

UNIT:mm

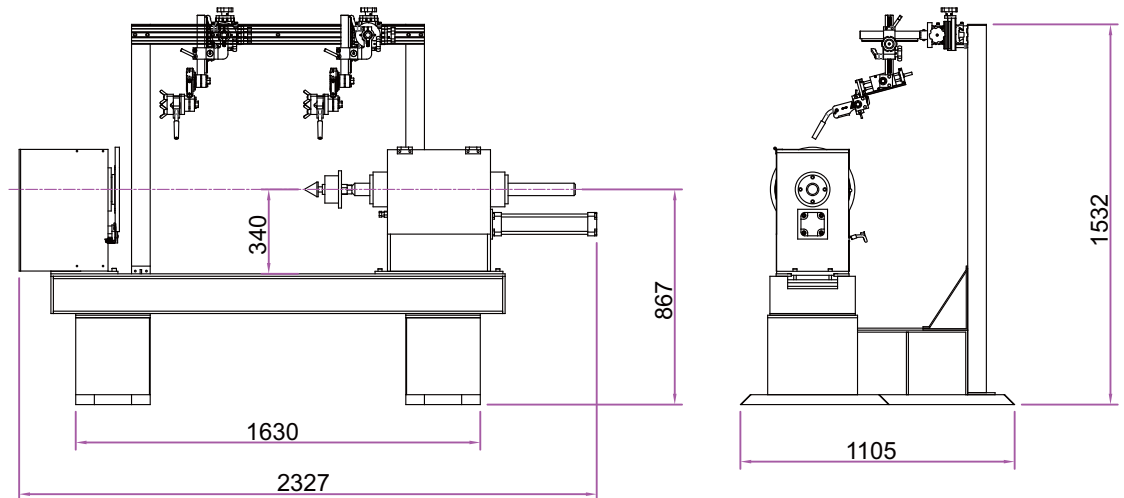

HPW340-L70T2 Eccentric Load

